

For Sale

EDSPENCER
REAL ESTATE

Fremont County, IA

151.99
TAXABLE ACRES M/L

\$8,500/ACRE

DIRECTIONS TO THE FARM: Farm is located approximately 2 miles Northwest of Anderson Iowa at the Intersection of 150th St and 290th Ave. Signs Posted.

BRIEF LEGAL DESCRIPTION: The SW ¼ Section 25, Township 70 (Green), Range 42, Except Parcel A located in the SW ¼ SW ¼, all in Fremont County, Iowa.

TAXABLE ACRES: 151.99 per Fremont County Iowa Assessor.

CSR2: 76.4 per Surety Maps on the tillable acres.

FSA INFORMATION: Farm# 5668 Tract# 4722

CROPLAND ACRES: 124.70 acres

CORN BASE: 60.26 PLC Yield 164

BEAN BASE: 60.26 PLC Yield 45

Balance in Creek and many Hardwood Trees. This would make an ideal farm with hunting potential.

POSSESSION: New buyer will assume the 50%/50% crop share lease and pay the landlords share of expenses at closing.

For more information, contact Ed Spencer, Broker at 402-510-3276.

T70N R42W
SEC 25



EDSPENCER
REAL ESTATE

Ed Spencer, Broker 402-510-3276

WWW.SPENCERGROUPS.COM

Spencer Groups, Inc. | 322 E 7th St, Logan, IA 51546

Abbreviated 156 Farm Record

Operator Name :
 CRP Contract Number(s) : None
 Recon ID : 19-071-2023-55
 Transferred From : None
 ARCPLC G//F Eligibility : Eligible

Farm Land Data

Farmland	Cropland	DCP Cropland	WBP	EWP	WRP	GRP	Sugarcane	Farm Status	Number of Tracts
155.78	124.70	124.70	0.00	0.00	0.00	0.00	0.0	Active	1
State Conservation	Other Conservation	Effective DCP Cropland		Double Cropped		CRP	MPL	DCP Ag.Rel. Activity	SOD
0.00	0.00	124.70		0.00		0.00	0.00	0.00	0.00

Crop Election Choice

ARC Individual	ARC County	Price Loss Coverage
None	CORN, SOYBN	None

DCP Crop Data

Crop Name	Base Acres	CCC-505 CRP Reduction Acres	PLC Yield	HIP
Corn	60.26	0.00	164	0
Soybeans	60.26	0.00	45	0
TOTAL	120.52	0.00		

NOTES

--

Tract Number : 4722

Description :
 FSA Physical Location : IOWA/FREMONT
 ANSI Physical Location : IOWA/FREMONT
 BIA Unit Range Number :
 HEL Status : HEL field on tract.Conservation system being actively applied
 Wetland Status : Wetland determinations not complete
 WL Violations : None
 Owners : JAYNE A BAUGH
 Other Producers : None
 Recon ID : 19-071-2023-54

Tract Land Data

Farm Land	Cropland	DCP Cropland	WBP	EWP	WRP	GRP	Sugarcane
155.78	124.70	124.70	0.00	0.00	0.00	0.00	0.0

Abbreviated 156 Farm Record

Tract 4722 Continued ...

State Conservation	Other Conservation	Effective DCP Cropland	Double Cropped	CRP	MPL	DCP Ag. Rel Activity	SOD
0.00	0.00	124.70	0.00	0.00	0.00	0.00	0.00

DCP Crop Data

Crop Name	Base Acres	CCC-505 CRP Reduction Acres	PLC Yield
Corn	60.26	0.00	164
Soybeans	60.26	0.00	45
TOTAL	120.52	0.00	

NOTES

--

In accordance with Federal civil rights law and U.S. Department of Agriculture (USDA) civil rights regulations and policies, the USDA, its Agencies, offices, and employees, and institutions participating in or administering USDA programs are prohibited from discriminating based on race, color, national origin, religion, sex, gender identity (including gender expression), sexual orientation, disability, age, marital status, family/parental status, income derived from a public assistance program, political beliefs, or reprisal or retaliation for prior civil rights activity, in any program or activity conducted or funded by USDA (not all bases apply to all programs). Remedies and complaint filing deadlines vary by program or incident.

Persons with disabilities who require alternative means of communication for program information (e.g., Braille, large print, audiotope, American Sign Language, etc.) should contact the responsible Agency or USDA: TARGET Center at (202) 720-2600 (voice and TTY) or contact USDA through the Federal Relay Service at (800) 877-8339. Additionally, program information may be made available in languages other than English.

To file a program discrimination complaint, complete the USDA Program Discrimination Complaint Form, AD-3027, found online at http://www.ascr.usda.gov/complaint_filing_cust.html and at any USDA office or write a letter addressed to USDA and provide in the letter all of the information requested in the form. To request a copy of the complaint form, call (866) 632-9992. Submit your completed form or letter to USDA by: (1) mail: U.S. Department of Agriculture Office of the Assistant Secretary for Civil Rights 1400 Independence Avenue, SW Washington, D.C. 20250-9410; (2) fax: (202) 690-7442; or (3) e-mail: program.intake@usda.gov. USDA is an equal opportunity provider, employer, and lender.



- Legend**
- Non-Cropland
 - Cropland
 - CRP
 - Iowa PLSS
 - Tract Boundary
 - Iowa Roads

- Wetland Determination Identifiers**
- Restricted Use
 - ▼ Limited Restrictions
 - Exempt from Conservation Compliance Provisions

Tract Cropland Total: 124.70 acres

2023 Program Year
Map Created April 28, 2023

Farm 5668
Tract 4722

United States Department of Agriculture (USDA) Farm Service Agency (FSA) maps are for FSA Program administration only. This map does not represent a legal survey or reflect actual ownership; rather it depicts the information provided directly from the producer and/or National Agricultural Imagery Program (NAIP) imagery. The producer accepts the data 'as is' and assumes all risks associated with its use. USDA-FSA assumes no responsibility for actual or consequential damage incurred as a result of any user's reliance on this data outside FSA Programs. Wetland identifiers do not represent the size, shape, or specific determination of the area. Refer to your original determination (CPA-026 and attached maps) for exact boundaries and determinations or contact USDA Natural Resources Conservation Service (NRCS).

Soils Map

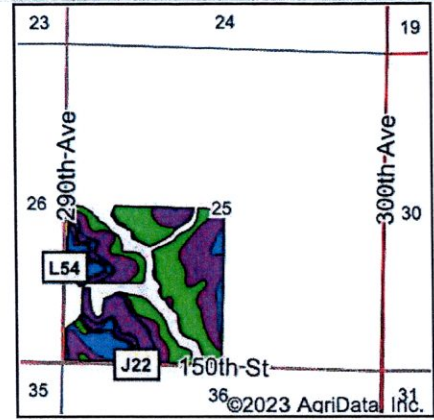
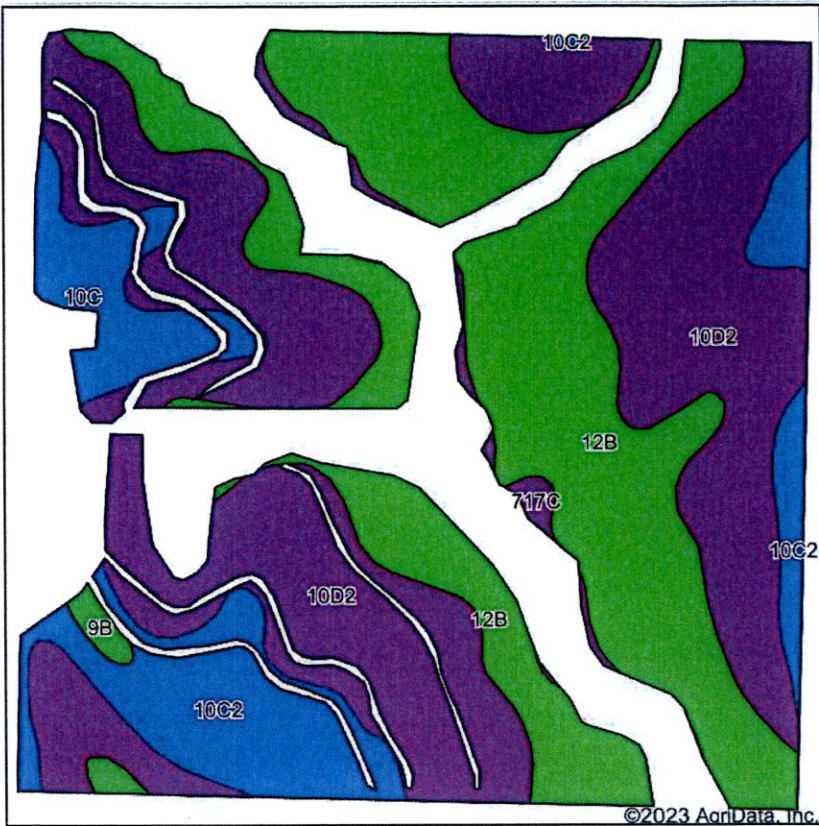

State: Iowa
 County: Fremont
 Location: 25-70N-42W
 Township: Green
 Acres: 120.64
 Date: 10/3/2023

Maps Provided By:







 CUSTOMIZED ONLINE MAPPING
 © AgriData, Inc. 2023 www.AgriDataInc.com



Soils data provided by USDA and NRCS.

©2023 AgriData, Inc.

Area Symbol: IA071, Soil Area Version: 29

Code	Soil Description	Acres	Percent of field	CSR2 Legend	Non-Irr Class *c	Irr Class *c	*i Corn Bu	*i Soybeans Bu	CSR2**	CSR	*n NCCPI Soybeans	
10D2	Monona silt loam, 9 to 14 percent slopes, eroded	55.62	46.1%		IIIe		177.6	51.5	60	53	70	
12B	Napier silt loam, 2 to 5 percent slopes	43.85	36.3%		IIe		230.4	66.8	93	77	90	
10C2	Monona silt loam, 5 to 9 percent slopes, eroded	13.41	11.1%		IIIe		211.2	61.2	86	63	76	
10C	Monona silt loam, 5 to 9 percent slopes	5.65	4.7%		IIIe		216.0	62.6	89	65	89	
717C	Napier-Gullied land complex, 2 to 10 percent slopes	1.49	1.2%		IIIe	IVe	88.0	25.5	55	5	10	
9B	Marshall silty clay loam, 2 to 5 percent slopes	0.62	0.5%		IIe		232.0	67.3	95	85	76	
Weighted Average						2.63	*-	201.5	58.4	76.4	63	*n 78.1

**IA has updated the CSR values for each county to CSR2.

*i Yield data provided by the ISPAID Database version 8.1.1 developed by IA State University.

*n: The aggregation method is "Weighted Average using all components"

*c: Using Capabilities Class Dominant Condition Aggregation Method

*- Irr Class weighted average cannot be calculated on the current soils data due to missing data.

Soils data provided by USDA and NRCS.